

Soller
Objekt-Nr. 120715



PORTA MALLORQUINA®
Your home. Our passion.

Bright, modern villa with wonderful views over the bay of Port de Soller

living space: 291 m²

Perceel: 487 m²

Slaapkamers: 3

Badkamer: 3

Uitzicht op zee: ✓

LABEL_ENERGIEKLA in voorbereiding
SSE:

Prijs: € 2.700.000,-



Soller Objekt-Nr. 120715



Objektbeschrijving:

This modern and bright newly-built villa is situated in a residential area near to the beach, and offers breathtaking panoramic views of the harbour of Soller and the Tramuntana mountain range.

It is characterised by its unique design and functionality, and due to its southern orientation enjoys ample sunshine.

A living space of 290 sqm is spread over 3 levels. On the lowest level is the main access from the street via stairs or the lift, and its area of around 90 sqm houses a 2-car garage, a laundry room, and a technology room.

On the 98 sqm ground floor there are 3 bedrooms, each with its own bathroom, with beautiful views of the mountains and the bay.

Housed on the first floor with 102 sqm is the spacious living/dining area with open kitchen, with large windows allowing the entry of ample natural light. From the living room there is access to a terrace with an approx. 35 sqm porch.

From the garden a staircase leads up to the roof terrace with incomparable views. The terrace has been foreseen with connections for the fitting of a summer kitchen.

The property is equipped with the most modern technology including underfloor heating, air conditioning with heat pump, double-glazed windows with sun protection, and pre-installation for solar panels.

Soller

Objekt-Nr. 120715



Locatie en omgeving:

Sóller is an attractive village on the northwest coast of Mallorca, famous for its big fields of orange and lemon groves. It is situated in a solitary valley, which in past times was very difficult to reach overland because of the terrain. From the sea there was an active trade to the Port de Sóller. The golden valley, as it is called, is well worth a visit especially on the local railway.

Soller
Objekt-Nr. 120715



All information is correct to the best of our knowledge. Errors and prior sale excepted. This prospectus is purely for information purposes. Only the notarized deed of sale is legally binding.

PORTA MALLORQUINA • C./ CONQUISTADOR 8, 07001 PALMA
TEL. +34 971 698 242 • INFO@PORTAMALLORQUINA.COM

Soller
Objekt-Nr. 120715



All information is correct to the best of our knowledge. Errors and prior sale excepted. This prospectus is purely for information purposes. Only the notarized deed of sale is legally binding.

PORTA MALLORQUINA • C./ CONQUISTADOR 8, 07001 PALMA
TEL. +34 971 698 242 • INFO@PORTAMALLORQUINA.COM

Soller
Objekt-Nr. 120715

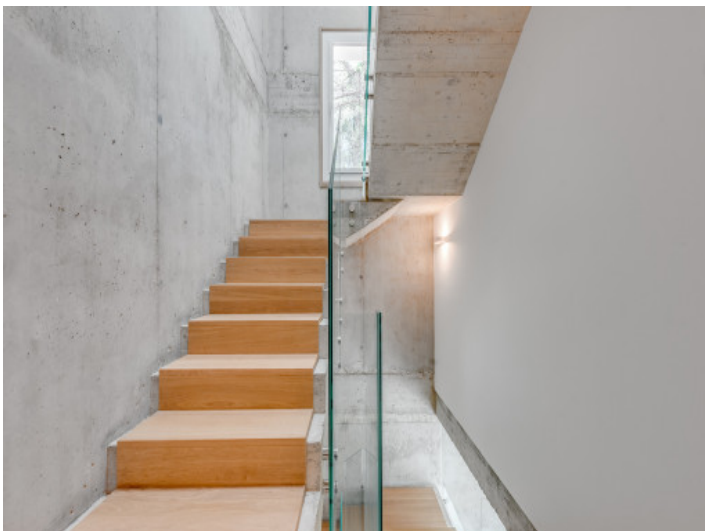
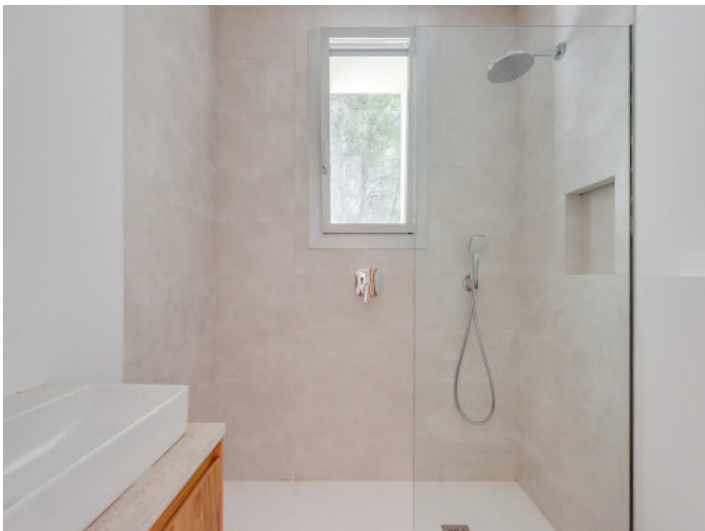

All information is correct to the best of our knowledge. Errors and prior sale excepted. This prospectus is purely for information purposes. Only the notarized deed of sale is legally binding.

Soller
Objekt-Nr. 120715



PORTA MALLORQUINA®
Your home. Our passion.



All information is correct to the best of our knowledge. Errors and prior sale excepted. This prospectus is purely for information purposes. Only the notarized deed of sale is legally binding.

PORTA MALLORQUINA • C./ CONQUISTADOR 8, 07001 PALMA
TEL. +34 971 698 242 • INFO@PORTAMALLORQUINA.COM